

EXISTING & PROPOSED BUILDING PLAN OF
 COMMERCIAL COLONY (LICENCE No. 54
 OF 2009 DATED 28.08.2009) FOR AERENS
 GOLDSOUK PROJECT (HISAR) PVT. LTD.
 SITUATED AT SECTOR - 25, HISAR.

SCALE :- 1 CM = 200 CM

DRG. No. - 7.

INDEX :-

EXISTING AREA SHOWN AS = 

PROPOSED AREA SHOWN AS = 

This is a "PROVISIONAL BUILDING PLAN" approved only for the purpose of inviting objections from the general public.

CTU (HR) cum chairman BPAC
 STR (HISAR) Member BPAC
 STP (HQ) Member Secretary BPAC
 JE
 PA ATP

DTP (HQ) ATP (HQ)

Parveen Kumar J.D.

TO BE FILED WITH THIS OFFICE
 FILE NO.:
 DATED:

APPLICANT SIGN.

For Aerens Gold Souk Project (Hisar) Pvt. Ltd.

 Authorised Signatory

ENGINEER

T.D. ANJIA
 M.E. STRUCTURES
 CHARTERED ENGINEER (F-1054277)
 CIP REG. NO. T350A
 9810076111, 9810078111
 Email: tdanija1905@gmail.com
 480 HERVO APARTMENTS, SEC-36, GGN-122011

Binayak Swain
 Structural Engineer, T.P. No. 10223
 Shop No. 2, Gupta Complex, Gop. Pusa Office
 First Floor, Sector-14, GGN (HR.)

ARCHITECT

 DTP (HQ) Member BPAC

Checked and found ok for Public Health (Internal) Service only subject to comments in forwarding letter No. 115.66...DU.12/01/2021

 Superintending Engineer (HQ)
 for Chief Engineer-I
 HSPV, Panchkula

PROPOSED COVD. AREA ON MUMTTY
 DETAIL '05' = $(6.74 + 6.60) \times (4.17 + 3.64) / 2$
 = 26.079 SQMT.
 = 26.079 + 26.079 = 52.158 SQMT.
 DETAIL '06' = 2.31 X 4.36
 = 10.071 SQMT.
 = 10.071 + 10.071 = 20.142 SQMT.
 TOTAL PROPOSED COVD. AREA ON STILT PARKING
 52.158 + 20.142 = 72.300 SQMT.

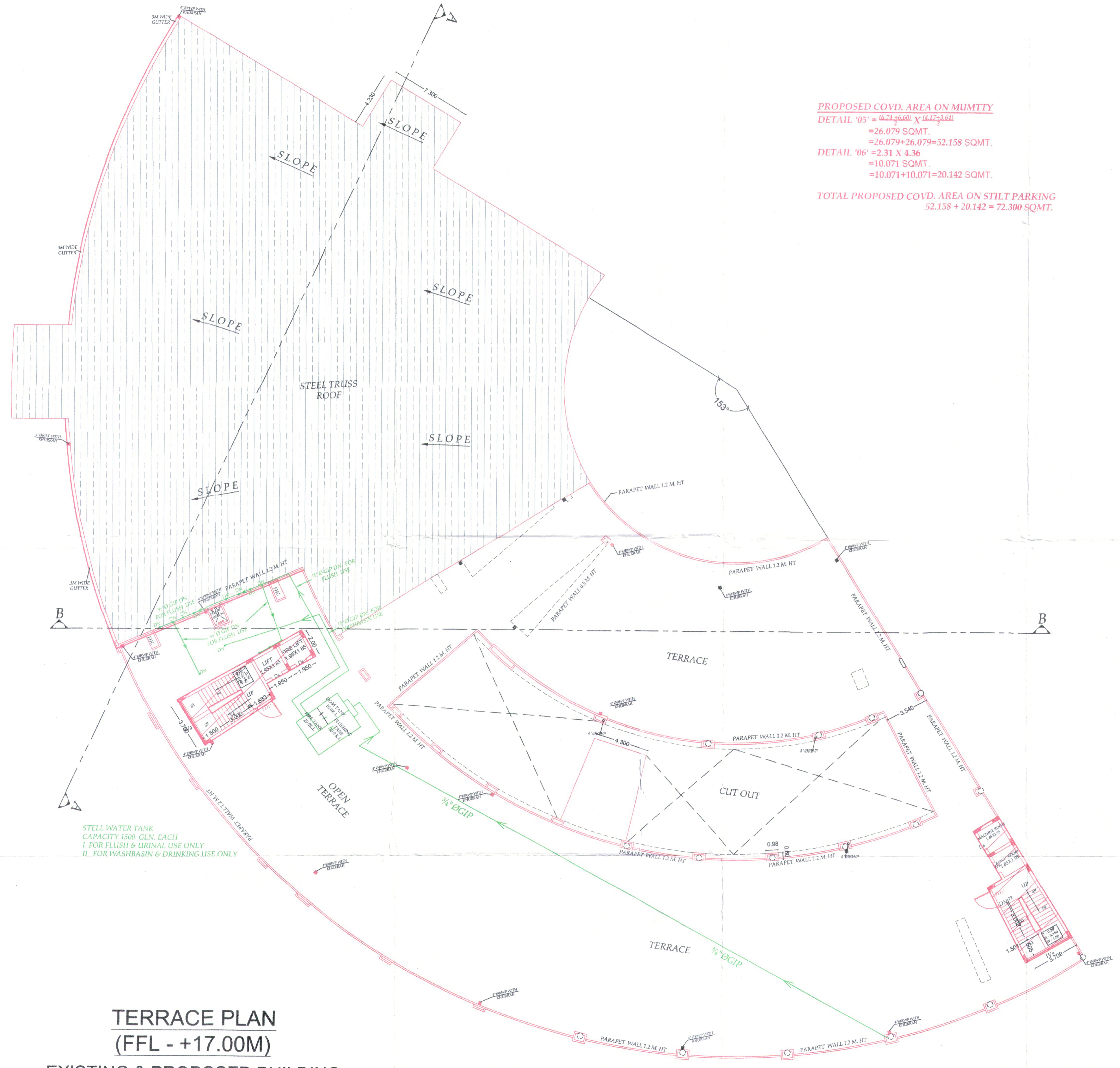

TERRACE PLAN
(FFL - +17.00M)
EXISTING & PROPOSED BUILDING

STEEL WATER TANK
 CAPACITY 1500 GLN. EACH
 I FOR FLUSH & URINAL USE ONLY
 II FOR WASHBASIN & DRINKING USE ONLY